

Nailstrip

A one-step insulation and nailable surface.

Branch River nailstrip consists of factory installed furring strips and UL Classified Branch River insulation rigid insulation. It is an ideal insulation and nailable surface when applied over structurally sound walls such as poured concrete, concrete block, brick, wood, and steel framing. Stability makes Branch River nailstrip perfect for both interior and exterior residential and commercial wall applications.

- Saves labor with one-step installation
- Various size panels are available - 16" or 24" o.c.
- Saves energy - no thermal breaks
- Interior - eliminates labor intensive framing
- Exterior - retrofit can occur without disruption of inside living areas

Thickness/R-value.

 Thickness	R-value ¹	
	75°F ²	40°F ³
1 1/2	5.8	6.3
2	7.7	8.3
2 1/2	9.6	10.4
3	11.6	12.5
3 1/2	13.5	14.6
4	15.4	16.7
4 1/2	17.3	18.8

¹ R-value units are °F-ft²-h/Btu.

² Recommended for design in WARM climates.

³ Recommended for design in COLD climates.

Proven to meet, or exceed, building codes.

Branch River nailstrip is manufactured under an industry leading quality control program monitored by UL and further recognized in UL Evaluation Report UL ER40326-01. Branch River nailstrip meets ASTM C578, "Standard Specification for Rigid, Cellular Polystyrene Thermal Insulation".

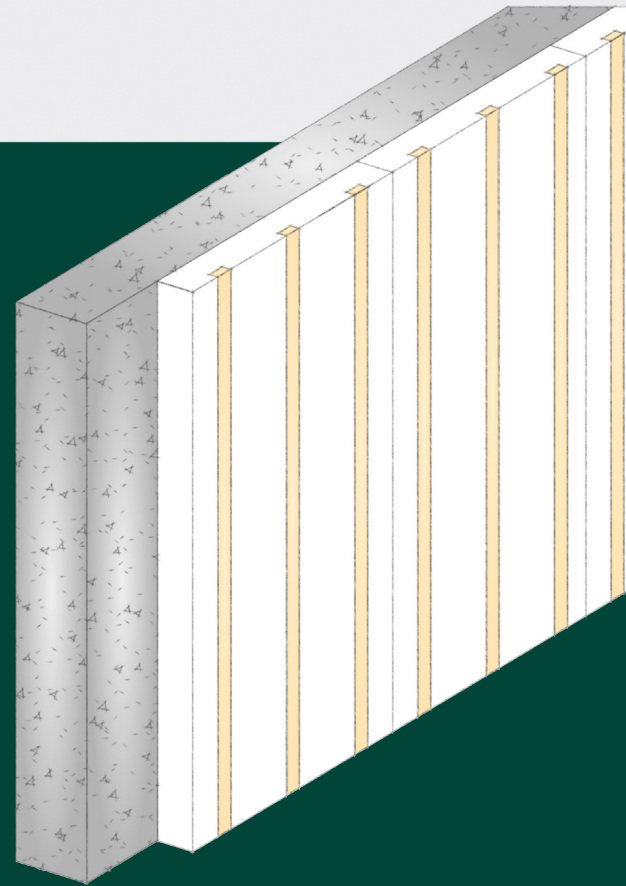

FOAM FACTS:

Branch River nailstrip outperforms other products.

- Branch River nailstrip has factory installed furring strips at 16" or 24" o.c.
- Branch River nailstrip can easily vary strength, thickness, and size to meet project R-values
- Branch River nailstrip is less-expensive than XPS and ISO products
- Branch River nailstrip has no long-term R-value loss or thermal drift
- Branch River nailstrip with borate treatment available to provide termite resistance

Energy Code Ci Requirements.

The use of continuous insulation is mandated by the 2012 International Energy Conservation Code (IECC). The IECC provides a prescriptive path for wall thermal insulation that includes the use of continuous insulation.

Walls, above grade			
Zone	IECC-2012 Prescriptive Ci R-value		
	Residential	Commercial	
	Wood-Framed Wall	Wood-Framed	
		All other	Group R
1	None	R-3.8 ¹	R-3.8 ¹
2	None	R-3.8 ¹	R-3.8 ¹
3	R-5 ¹	R-3.8 ¹	R-3.8 ¹
4 except Marine	R-5 ¹	R-3.8 ¹	R-3.8 ¹
5 and 4 Marine	R-5 ¹	R-3.8 ¹	R-7.5 ¹ R-3.8 ²
6	R-10 ¹ R-5 ²	R-7.5 ¹ R-3.8 ²	R-7.5 ¹ R-3.8 ²
7	R-10 ¹ R-5 ²	R-7.5 ¹ R-3.8 ²	R-7.5 ¹ R-3.8 ²
8	R-10 ¹ R-5 ²	R-10 ²	R-10 ²

¹ For use with R-13 cavity insulation

² For use with R-20 cavity insulation

Installation.

Installation shall be in strict accordance with published instructions, details, and drawings that are part of the contract documents for the project.

1. Branch River nailstrip must be installed over a structurally sound substrate.

2. Mechanically fasten Branch River nailstrip with Branch River fasteners or other approved fasteners long enough to penetrate the structural substrate to provide adequate holding power.

Note: Fastener types, installation, and spacing should be designed on an individual project basis. For specific fastening recommendations, please contact a sales representative or refer to the Branch River Nailstrip Construction Manual and Technical Bulletins.

3. Provide continuous wood or metal blocking at all perimeters and openings.

4. Install weather resistive barriers and wall cladding materials per wall cladding manufacturer's specifications and recommendations for installation over continuous insulation.

Note: Climate conditions, code requirements, and building science dictate the use and position of vapor retarders within wall assemblies. Consult with local code officials and building science professional concerning the use of vapor retarders.

Ready to take control? Start here.

If you're ready to have Branch River contribute to your next project, just contact your Branch River Plastics, Inc. Technical Sales Representative. They will be happy to give you design consultation, information about Branch River products, pricing, and answers to all of your questions.



PLASTICS, INC.

15 Thurber Boulevard

Smithfield, RI 02917

P: 401-232-3434

www.branchriver.com



Branch River insulation products are manufactured by Branch River Plastics, Inc.

Copyright © 2020 Branch River Plastics, Inc.

UL logo is a registered trademark of UL LLC.

BRPNS01-11/20



www.branchriver.com

**MOLDED
POLYSTYRENE
INSULATION**